

Dimensions (inches)

PUMP MODEL	A	B	C	D	E	F	G	H	J	K
LEM 110	5.88	5.80	11.26	7.50	9.50	23.11	9.35	5.50	7.50	8.50
LEM 170	7.38	6.00	13.40	8.50	10.50	25.22	10.90	6.25	9.00	10.00

For connection sizes/ratings and motor sizes refer to engineering data table on reverse.

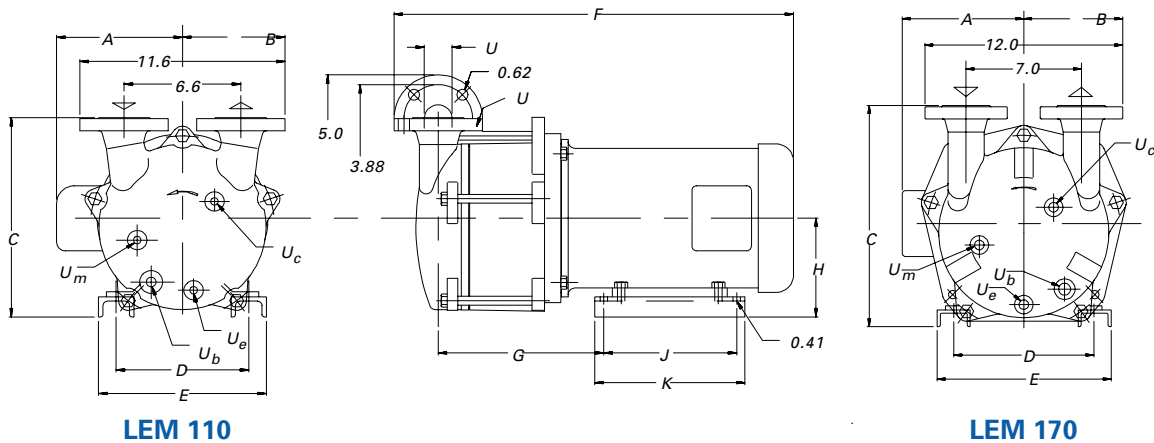

Capacity Table

Pump Model - LEM 110														
Speed (RPM)	6" Hg. V. 608 Torr		12" Hg. V. 455 Torr		18" Hg. V. 303 Torr		22" Hg. V. 201 Torr		24" Hg. V. 150 Torr		28" Hg. V. 49 Torr		28.9" Hg. V. 25 Torr	
	cfm	HP	cfm	HP	cfm	HP	cfm	HP	cfm	HP	cfm	HP	cfm	HP
1750	76.5	4.9	76.0	5.0	76.0	5.0	75.5	5.0	74.0	5.0	52.0	3.7	35.0	2.8
Pump Model - LEM 170														
1750	102	6.2	109	7.2	116	7.5	117	7.5	113	7.5	74	5.7	46	5.0
1450	79	4.2	85	4.4	90	5.4	92	5.6	90	5.4	48	4.0	22	3.3
Pump Model														

This data represents average values for pumps in standard materials. Capacity in cubic feet per minute at 68°F (20°C) using 60°F (15°C) water as a service liquid. Vacuum in inches Hg. Barometric pressure at sea level 29.92" Hg. abs. (760 Torr).

All performance data per HEI standards; subject to SIHI standard tolerances.

All data subject to change without notice.



ENGINEERING DATA

PUMP MODEL	LEMA 110	LEMA 170	
Gas Conn. Size -'U'	1)	1)	
Ser. Liq. Line Qty/Size -"U _B "	½" NPT	½" NPT	
Drain (U _D) & Cav. (U _C) Size	3/8" NPT	3/8" NPT	
Pump & Motor Wt. (lb.)	125	150	
Separator Size-Recirc (G)	10	10	
2) 3) Norm Max. Gas Temp. (°F)	200	200	
Norm Max. Liq. Temp. (°F)	180	180	
Sound Level @24" Hg. (dBA)	77	79	
4) Casing Max. WP/Hydro	30/45	30/45	
Motor Data			
Motor Speed @ 60 HZ.	1750	1750	
Motor Speed @ 50 HZ.	1450	1450	
Std. HP/Frame @ 60 HZ.	5 / 184 TCZ	7½ / 213 TCZ	
Std. HP/Frame @ 50 HZ.	4 / 184 TCZ	6 / 213 TCZ	
Std. Motor Enclosure	TEFC	TEFC	
Motor Code Approvals	UL,CSA	UL,CSA	
Std. Service Factor	1.15	1.15	
Stock Voltages	208/230/460	208/230/460	
	575	575	
Alt Enclosures Available	XPFC1GRD	XPFC1GRD	

- 1) Mating flange 1½", 150# R.F.
- 2) Max. temp. with saturated gases.
- 3) Higher temp. possible on request
- 4) At 3 ft., 1750 RPM with motor (not certified)

SECTIONAL

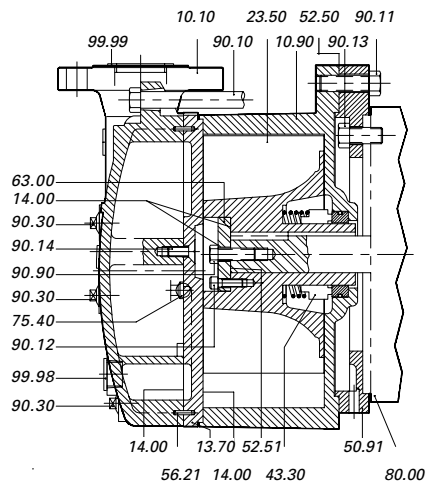

MATERIALS

ITEM	OA	OE	4B	OTHER ⁶
Casing-Wetted	Cast Iron	Cast Iron	316 SS	
Intermediate	Cast Iron	Cast Iron	316 SS	
Impeller	Bronze	316 SS	316 SS	
⁵ Motor Shaft	Carbon Steel	Carbon Steel	Carbon Steel	
Mechanical Shaft	AAA ⁷	AAA ⁷	AAB ⁸	

⁵ Motor shaft is a non-wetted part ⁶ Completed as Necessary ⁷ AAA =single bellows seal with buna elastomers, carbon vs ceramic faces
⁸ AAB =single bellows seal with viton elastomers, carbon vs SiC faces

All data subject to change without notice.

SERVICE LIQUID RATES

PUMP MODEL- LEM 110															
Pump Speed	12" Hg. V. 455 Torr			16" Hg. V. 354 Torr			20" Hg. V. 252 Torr			24" Hg. V. 150 Torr			28" Hg. V. 49 Torr		
	A	B	C	A	B	C	A	B	C	A	B	C	A	B	C
1750	1.8	1.1	0.7	2.3	1.2	0.8	3.1	1.5	1.0	3.5	1.5	1.0	3.9	1.3	0.8
1450		--	--		--	--		--	--		--	--		--	--
PUMP MODEL- LEM 170															
1750	3.1	1.7	1.2	3.8	1.9	1.3	3.8	2.0	1.3	4.4	2.0	1.3	4.4	1.8	1.1
1450		1.4	0.9		1.6	1.0		1.7	1.1		1.7	1.1		1.4	0.8
PUMP MODEL															

Column 'A' is the flow in USGPM required - once through.
 Column 'B' is the make-up flow required when make-up water is 5°C (9°F) cooler than service water.
 Column 'C' is the make-up flow when make-up water is 10°C (18°F) cooler than service water.

PARTS LIST

- 10.10 Cover
- 10.90 Centerbody
- 13.70 Intermediate
- 14.00 Gasket-Liquid
- 23.50 Impeller
- 43.30 Mechanical Seal
- 50.91 Mounting Spacer
- 52.50 Shim Set
- 52.51 Shim Set
- 56.21 Locating Pin
- 63.00 Impeller Plate
- 75.40 Orifice Ball
- 80.00 Motor
- 90.10 Bolt
- 90.11 Bolt
- 90.12 Cylinder Screw
- 90.13 Bolt
- 90.14 Machine Screw
- 90.30 Plug
- 90.90 Bolt
- 99.98 Plug - Plastic
- 99.99 Plug - Plastic

