

Dimensions (inches)¹

PUMP MODEL	A	B	C	D	E	F	G	H	J	K
LEM 250	9.51	7.00	14.85	10.00	13.00	31.09	10.41	7.25	14.00	16.00

1) Standard motor only. For connection sizes/ratings and motor sizes refer to engineering data table on reverse.

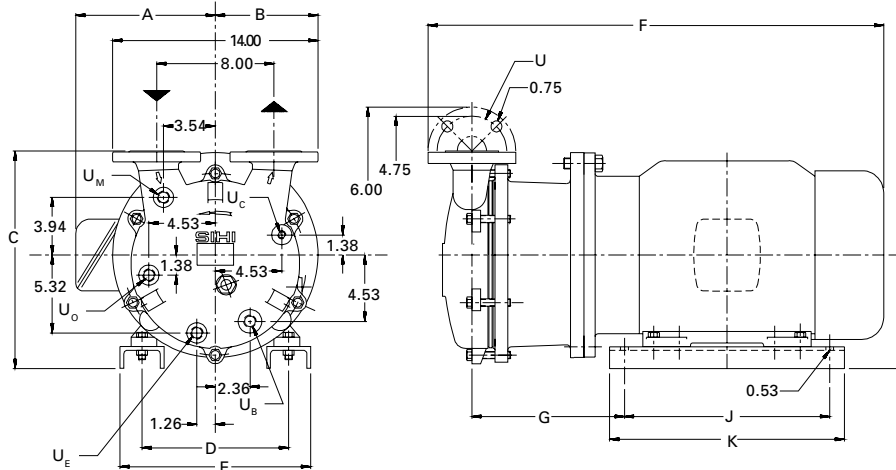

Capacity Table

Pump Model - LEM 250														
Speed (RPM)	6" Hg V. 608 Torr		12" Hg V. 455 Torr		18" Hg V. 303 Torr		22" Hg V. 201 Torr		24" Hg V. 150 Torr		28" Hg V. 49 Torr		28.9" Hg V. 25 Torr	
	cfm	HP	cfm	HP	cfm	HP	cfm	HP	cfm	HP	cfm	HP	cfm	HP
1750	149	8.6	151	9.4	153	10.2	154	9.9	150	9.8	110	6.8	80	6.7
1450	121	5.4	123	6.4	125	6.8	126	7.0	125	6.7	90	5.0	68	4.3
Pump Model														
Pump Model														

This data represents average values for pumps in standard materials. Capacity in cubic feet per minute at 68°F (20°C) using 60°F (15°C) water as a service liquid. Vacuum in inches Hg. Barometric pressure at sea level 29.92" Hg abs.

All performance data per HEI standards; subject to SIHI standard tolerances.

All data subject to change without notice.

04.LEM250.01



ENGINEERING DATA

PUMP MODEL	LEM 250		
Gas Conn. Size/Rating- (U)	2"/150RF		
Svc. Liq. Line (U _g) Size/Rating	½"/NPT		
Drain (U _d) Size/Rating	½"/NPT		
Anti-Cav. (U _c) Size/Rating	¼"/NPT		
Pump & Motor Wt. (lb.)	375		
1,2 Separator Size-Recirc. (Gal.)	10		
Norm Max. Gas Temp. (°F)	200		
Norm Max. Liq. Temp. (°F)	180		
3 Sound Level @ 24" Hg (dBA)	82		
Casing Max. WP/Hydro	30/45		
Motor Data			
Motor Speed @ 60 HZ.	1750		
Motor Speed @ 50 HZ.	1450		
Std. HP/Frame @ 60 HZ.	10/254 TD		
Std. HP/Frame @ 50 HZ.	8/254 TD		
Std. Motor Enclosure	TEFC		
Motor Code Approvals	UL, CSA		
Std. Service Factor	1.15		
Stock Voltages	208/230/460		
	575		
Alt Enclosures Available	XPFC11GPD		

- 1) Max. temp. with saturated gases.
- 2) Higher temp. possible on request.
- 3) At 3 ft., 1750 RPM with motor (not certified).

SERVICE LIQUID RATES

PUMP MODEL- LEM 250															
Pump Speed	12" Hg V. 455 Torr			16" Hg V. 354 Torr			20" Hg V. 252 Torr			24" Hg V. 150 Torr			28" Hg V. 49 Torr		
	A	B	C	A	B	C	A	B	C	A	B	C	A	B	C
1750	3.3	1.7	1.3	3.8	2.0	1.4	4.3	2.2	1.5	4.7	2.4	1.6	5.2	2.2	1.4
1450		1.0	0.6		1.7	1.1		1.9	1.2		2.0	1.3		1.7	1.0

PUMP MODEL

PUMP MODEL

Column 'A' is the flow in USGPM required - once through.
 Column 'B' is the make-up flow required when make-up water is 5°C (9°F) cooler than service water.
 Column 'C' is the make-up flow when make-up water is 10°C (18°F) cooler than service water.

SECTIONAL

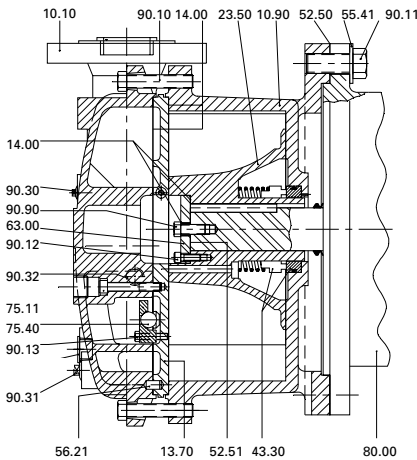

PARTS LIST

- 10.10 Cover
- 10.90 Centerbody
- 13.70 Intermediate
- 14.00 Gasket-Liquid
- 23.50 Impeller
- 43.30 Mechanical Seal
- 52.50 Shim Set
- 52.51 Shim Set
- 55.41 Washer
- 56.20 Locating Pin
- 56.21 Locating Pin
- 63.00 Impeller Plate
- 75.11 Orifice Plate
- 75.40 Orifice Ball
- 80.00 Motor
- 90.10 Bolt
- 90.11 Bolt
- 90.12 Cylinder Screw
- 90.13 Bolt
- 90.30 Plug
- 90.31 Plug
- 90.32 Plug
- 90.90 Bolt

MATERIALS

ITEM	OA	OE	4B	OTHER⁵
Casing-Wetted	Cast Iron	Cast Iron	316 SS	
Intermediate	Cast Iron	Cast Iron	316 SS	
Impeller	Bronze	316 SS	316 SS	
4 Motor Shaft	Carbon Steel	Carbon Steel	Carbon Steel	
Mechanical Shaft Seal	AAA ⁶	AAA ⁶	AAB ⁷	

⁴Motor shaft is a non-wetted part ⁵Completed as Necessary ⁶ AAA =single bellows seal with buna elastomers, carbon vs ceramic faces
⁷AAB =single bellows seal with viton elastomers, carbon vs SiC faces

All data subject to change without notice.

